

Micro pressure regulators Series CLR

Ports G1/4, G1/8

Micro pressure regulators with banjo in technopolymer

- » Extreme lightness in weight
- » Compact
- » In-line or panel mounting



Series CLR micro pressure regulators are available with G1/8 and G1/4 connections. A piston with relieving and VS function (valve with fast draining) has been incorporated into its design. The body is in brass, while the connection fitting is in technopolymer which guarantees maximum lightness. With a threaded top part of the body both direct mounting to a valve outlet (1/8 and 1/4 threads) and panel mounting are easily facilitated.

The pressure is precisely regulated simply by turning the polymer knob with a locking nut available to set the desired output.

GENERAL DATA

Construction	piston
Materials	brass body, technopolymer banjo, stainless steel spring; NBR O-ring
Ports	G1/8 - G1/4
Weight	Kg 0,035
Mounting	in-line or panel mounting (in any position)
Operating temperature	-5°C ÷ 50°C (with the dew point of the fluid lower than 2°C at the min. working temperature)
Inlet pressure	2 ÷ 10 bar
Outlet pressure	0,5 ÷ 10 bar
Nominal flow	see graphs
Secondary pressure relieving	standard (all regulators are provided with high relief flow VS function)

CODING EXAMPLE

CL	R	1/8	-	4
----	---	-----	---	---

CL	SERIES
R	R = REGULATOR
1/8	PORTS: 1/8 = G1/8 1/4 = G1/4
4	TUBE: 4 = Ø4 mm (G1/8 only) 6 = Ø6 mm 8 = Ø8 mm

3

TREATMENT

FLOW DIAGRAMS

New

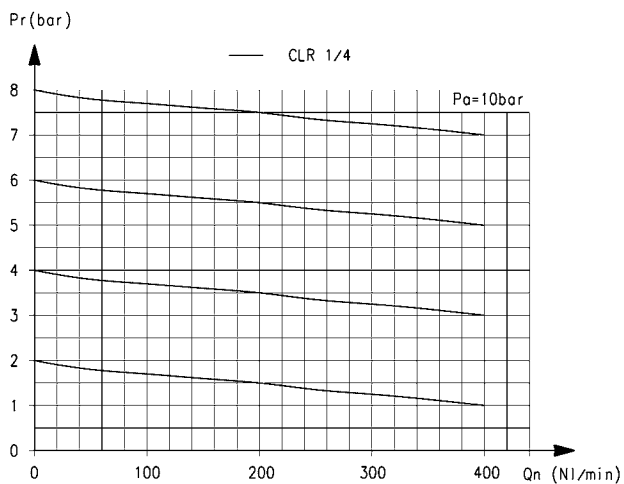

Pa = Inlet pressure (10 Bar) -
 Pr = Regulated pressure - Q = Flow
 CLR 1/4-6 6 bar $\Delta P1 = 209$ NI/min
 CLR 1/4-8 6 bar $\Delta P1 = 310$ NI/min

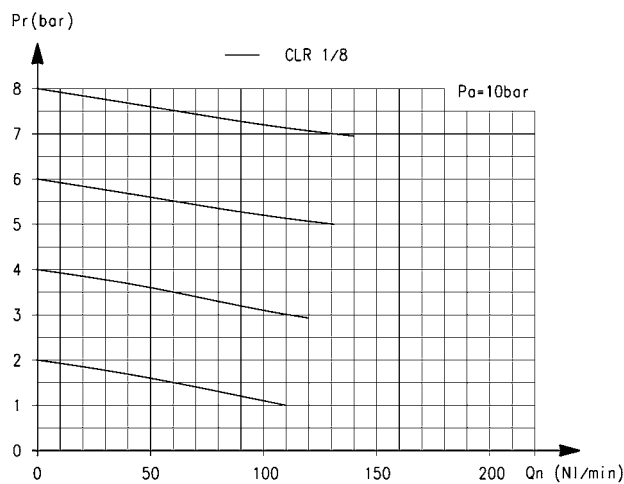

Pa = Inlet pressure (10 Bar) -
 Pr = Regulated pressure - Q = Flow
 CLR 1/8-4 6bar $\Delta P1 = 90$ NI/min - CLR 1/8-6 6bar $\Delta P1 = 120$ NI/min
 CLR 1/8-8 6bar $\Delta P1 = 120$ NI/min

Micro pressure regulators Series CLR

New

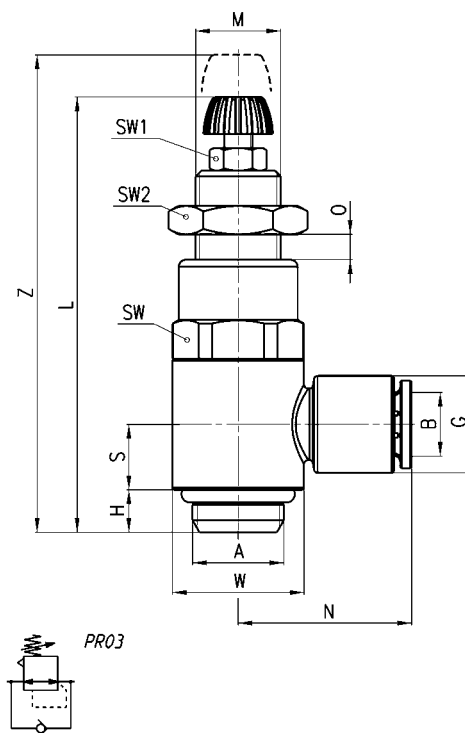

Mod.	A	B	G	H	L	M	N	O	S	W	SW	SW1	SW2	Z
CLR 1/8-4	G1/8	4	11,6	5	52	M11x1	21	0+6,5	7,75	14	14	7	14	59
CLR 1/8-6	G1/8	6	11,6	5	52	M11x1	21	0+6,5	7,75	14	14	7	14	59
CLR 1/8-8	G1/8	8	13,9	5	52	M11x1	22,5	0+6,5	7,75	14	14	7	14	59
CLR 1/4-6	G1/4	6	13,9	6	59,5	M12x1	24,5	0+8	9,25	18,6	17	7	17	68
CLR 1/4-8	G1/4	8	13,9	6	59,5	M12x1	24,5	0+8	9,25	18,6	17	7	17	68